

SHP Series

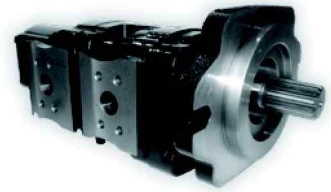

Feature

SHP pumps set the standard for superior performance and reliability in heavy-duty hydraulic application. Low-friction bushings provide strength, high efficiency, and long life in severe operation environments. SHP pumps are available in multiple assemblies combined with SMP series pumps.

Application

SHP Pumps are designed to be suitable for using in a wide range of integral valves for power steering, power brakes, fan drives and implement of hydraulics. Optimized specification for OEM application is available.

Dimensions

1) B type (Code No : SHP 350 S F3 SP - SMP20 160 S E2 U4 - SMP20 160 S 00 U4 - B3 P6 R - 0)

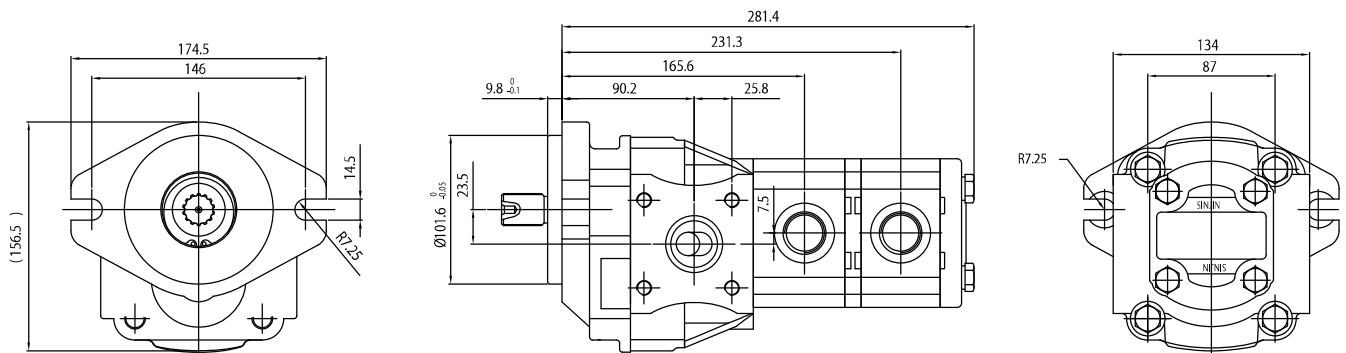

2) C type (Code No : SHP 350 S F3 SP - SHP 350 S F3 U5 - SMP20 160 S 00 U4 - C1 P6 R - 0)

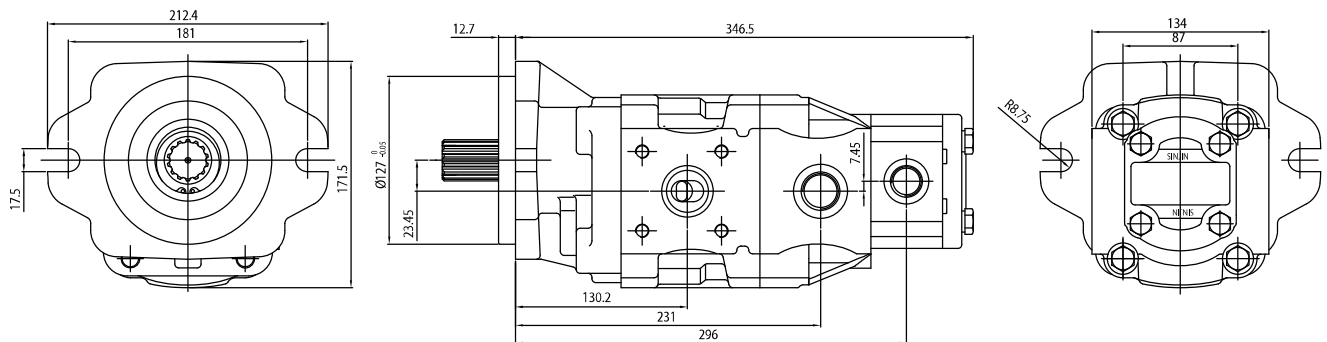

Triple PUMP

Classification	1st Pump	2nd Pump	3rd Pump
Displacements	27~46 cm ³ /rev	4.8~46 cm ³ /rev	4.8~28 cm ³ /rev
Max. Continuous Pressure	260 bar	260 bar	250 bar
Speed	from 500 to 3000 rpm		

Tandem PUMP

Classification	1st Pump	2nd Pump
Displacements	27~46 cm ³ /rev	4.8~28 cm ³ /rev
Max. Continuous Pressure	260 bar	250 bar
Speed	from 500 to 3000 rpm	

Code and Specification (Triple Pump)

SHP 350 S F3 SP - SHP 350 S F3 U6 - SMP20 160 S 00 U4 - C1 P6 R - 0

Series	
SHP	
SMP20	

Displacements		
	Code	cm ³ /rev
SHP	270	27
	350	35
	390	39
	440	44
SMP20	048	4.8
	060	6
	083	8.3
	113	11.3
	140	14
	160	16
	180	18
	200	20
	215	21.5
252	25.2	

Port Position
S : Side Port

Inlet/Outlet Port
00 : None
G3 : G3/8
G4 : G1/2
G5 : G3/4
G6 : G1
G7 : G1-1/4
U4 : 7/8-14UNF
U5 : 1-1/16-12UN
U6 : 1-5/16-12UN
F1 : SAE Split Port 1/2
F2 : SAE Split Port 3/4
F3 : SAE Split Port 1
F4 : SAE Split Port 1-1/4
F5 : SAE Split Port 1-1/2
F6 : SAE Split Port 2
SP : Special Port

Mounting Flange
B3 : SAE "B" 2 bolt
C1 : SAE "C" 2 bolt

Drive Shaft
P5 : SAE "B" Spline(13T)
P6 : SAE "C" Spline(14T)

Direction of Rotation
R : Clockwise
L : Counter Clockwise

Special Option
0 : None
1 : Priority Valve Attached